



GSM/3G & GPS Antennas

GLYN Ltd. Australia

Suite 7/201, Lakeside Corporate Centre
29-31 Solent Circuit, Norwest Business Park
Baulkham Hills, NSW 2154
Australia

Tel: +61-(0)2-8850-0320
Fax: +61-(0)2-8850-0370
Email: sales@glyn.com.au
Web: www.glyn.com.au

GLYN Ltd. New Zealand

Unit 5/18, Airborne Road
Albany 1311, Auckland
New Zealand

Tel. +64-(0)9-441-9050
Fax +64-(0)9-441-9060
Email: sales@glyn.co.nz
Web: www.glyn.co.nz

GLYN
High-Tech Distribution

TABLE OF CONTENTS

GSM/3G Antennas (External) -----	3
High Gain GSM/3G Antennas (External) -----	10
GSM/3G Antennas (Internal) -----	13
GPS Antennas -----	17
GSM + GPS Combo Antennas -----	24
RF Cables Pigtails -----	28
Recommended Configurations for Telit GSM/GPS Modules --	31
GLYN Standard Parts (Stocked Items) -----	36

GSM / 3G Antennas (External)

DUAL BAND GSM ANTENNA



AGM015D



AGM015DS

Technical Data

Applicable Bands: Dual Band 900/1800 MHz
Frequency Range: 880-960 MHz / 1710-1990 MHz
Bandwidth: ± 5 MHz
VSWR (5m): 2.0 : 1
Impedance: 50 ohm
Gain: 2 dBi
Max Input power: 60W
Polarization Type: Vertical
Dimension: 10.4 (D) x 55 mm (H)
Colour: Black
Connector Type: SMA male or other
Operating Temperature: -40°C to +85°C

TRI BAND GSM ANTENNA



Model No. AGM001T

Technical Data

Applicable Bands: Tri Band 900/1800/1900 MHz
Frequency Range: 880-960 MHz / 1710-1990 MHz
Bandwidth: ± 5 MHz
VSWR (5m): 2.0 : 1
Gain: 2 dBi
Max Input Power: 60 W
Impedance: 50 ohm
Polarization Type: Vertical
Dimension: 29 (D) x 120 mm (H)
Cable: RG174 3m, 5m, or others
Connector Type: SMA/MCX or others
Mounting: Magnetic
Housing: Black, IP67 rated
Operating Temperature: -40°C to +85°C

QUAD BAND GSM ANTENNAS



AGM000QRS
(SMA male connector)



AGM000QFF
(FME female connector)

Technical Data

Applicable Bands:
Quad band 850/900/1800/1900 MHz
Frequency Range:
824-894 MHz / 880-960 MHz / 1710-1990 MHz
Bandwidth: ± 5 MHz
VSWR (5m): 2.0 : 1
Impedance: 50 ohm
Gain: 2 dBi
Max Input power: 60W
Polarization Type: Vertical
Dimension:
9 (D) \times 89 mm (H) - QRS
8 (D) \times 115 mm (H) - QFF
Colour: Black
Connector Type: SMA male (QRS), FME female (QFF)
Operating Temperature: -40°C to +85°C

PENTA BAND GSM/3G ANTENNA

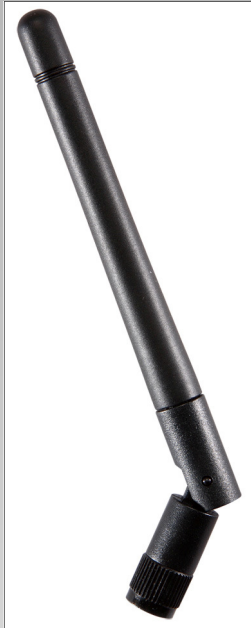

Model No. AGM000PFS

Technical Data

Applicable Bands: Penta Band 850/900/1800/1900/2100MHz

Frequency Range: 824-894 MHz / 880-960 MHz
1710-1990 MHz / 1920-2170 MHz

Bandwidth: ± 5 MHz

VSWR (5m): 2.0 : 1

Impedance: 50 ohm

Gain: 2 dBi

Max Input power: 60W

Polarization Type: Vertical

Dimension:

10 (D) \times 110 mm (H)

Colour: Black

Connector Type: SMA male

Operating Temperature: -40°C to +85°C

PENTA BAND GSM/3G ANTENNA



Model No. AGM001P

Technical Data

Applicable Bands: Penta Band 850/900/1800/1900/2100MHz
Frequency Range: 824-894 MHz / 880-960 MHz
1710-1990 MHz / 1920-2170 MHz

Bandwidth: ± 5 MHz

VSWR (5m): 2.0 : 1

Gain: 2 dBi

Max Input Power: 60 W

Impedance: 50 ohm

Polarization Type: Vertical

Dimension: 29 (D) x 120 mm (H)

Cable: RG174 3m, 5m, or others

Connector Type: SMA/MCX or others

Mounting: Magnetic

Housing: Black, IP67 rated

Operating Temperature: -40°C to +85°C

PENTA BAND GSM/3G ANTENNA



Model No. AGM002P

Technical Data

Applicable Bands: Penta Band 850/900/1800/1900/2100MHz
Frequency Range: 824-894 MHz / 880-960 MHz
1710-1990 MHz / 1920-2170 MHz

Bandwidth: ± 5 MHz

VSWR (5m): 2.0 : 1

Gain: 2 dBi

Max Input Power: 60 W

Impedance: 50 ohm

Polarization Type: Vertical

Dimension: 115 x 22 x 4 mm

Cable: RG174 3m, 5m, or others

Connector Type: SMA/MCX or others

Mounting: Adhesive

Housing: Black, IP67 rated

Operating Temperature: -40°C to +85°C

PENTA BAND GSM/3G ANTENNA



Model No. AGM018P

Technical Data

Applicable Bands: Penta Band 850/900/1800/1900/2100MHz
Frequency Range: 824-894 MHz / 880-960 MHz
1710-1990 MHz / 1920-2170 MHz

Bandwidth: ± 5 MHz

VSWR (5m): 2.0 : 1

Impedance: 50 ohm

Gain: 2 dBi

Max Input Power: 60 W

Polarization Type: Vertical

Dimension: 71 (D) x 17mm (H)

Cable: RG174 2m, 5m, or others

Connector Type:

SMA/MCX or others

Housing: Black, IP67 rated

Operating Temperature: -40°C to+85°C

PENTA BAND GSM/3G ANTENNA



Model No. AGM023P

Technical Data

Applicable Bands: Penta Band 850/900/1800/1900/2100MHz
Frequency Range: 824-960 MHz
1710-1990 MHz / 1920-2170 MHz

Bandwidth: ± 5 MHz

VSWR (5m): 2.0 : 1

Impedance: 50 ohm

Gain: 2 dBi

Dimension: 45 (D) x 75.5 mm (H)

Cable: RG58 30cm or others

Connector Type:

SMA/MCX or others

Housing: Black, IP67 rated

Operating Temperature: -40°C to+85°C

High Gain GSM/3G Antennas (External)

PENTA BAND GSM/3G ANTENNA

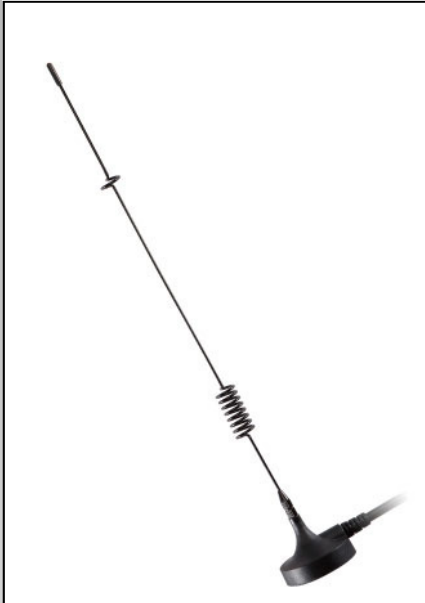

Model No. AGM024P

Technical Data

Applicable Bands: Penta Band 850/900/1800/1900/2100MHz
Frequency Range: 824-894 MHz / 880-960 MHz
1710-1990 MHz / 1920-2170 MHz

Bandwidth: ± 5 MHz
VSWR (5m): 2.0 : 1
Impedance: 50 ohm
Gain: 5 dBi
Max Input Power: 60 W
Polarization Type: Vertical
Dimension: 40 (D) x 295 mm
Cable: RG174 2m, 5m, or others
Connector Type:
SMA/MCX or others
Housing: Black, IP67 rated
Operating Temperature: -40°C to +85°C

DUAL BAND GSM/3G ANTENNA



Model No. AGM006D

Technical Data

Applicable Bands: Dual Band 850/900MHz
Frequency Range: 825-960 MHz
Gain: 6.1 dBi
Dimension: 800 mm
Cable: 5m low loss coaxial cable , or other lengths
Connector Type: FME, SMA male or others
Mounting: Screw-type, antenna has spring base

PENTA BAND GSM/3G ANTENNA



Model No. GL8/25-9

Electrical Data

Applicable Bands: GSM/3G Penta Band
850/900/1800/1900/2100MHz and ISM Band 2.4GHz
Frequency Range: 806-2500 MHz
Gain: 9dBi
VSWR: < 1.5
Polarisation: Vertical
Horizontal Beamwidth: 65°
Vertical Beamwidth: 55°
Nominal Impedance: 50 ohm
F/B Ratio: ≥ 14 dB
Max Input Power: 100W
Lightning Protection: DC Ground

Mechanical Data

Connector: SMA male (other connectors also available)
Dimension: 300 x 210 x 65 mm
Weight: 0.8 kg
Cable length: 10m LMR200 low loss cable (other cable lengths also available)
Reflector Material: Aluminum Alloy
Radome Material: Weatherproof ABS
Mounting Method: Mast
Mast Size: $\varnothing 40 - \varnothing 50$ mm
Rated Wind Velocity: 210km/hr
Operating Temperature: -40 to +65°C

Radiation Patterns

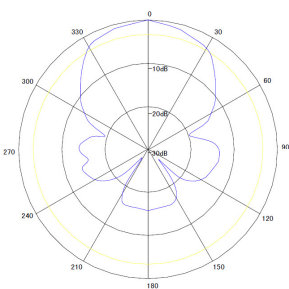

H-Plane

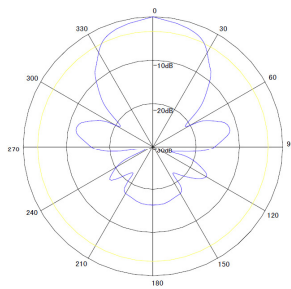

V-Plane

GSM/3G Antennas (Internal)

DUAL BAND GSM ANTENNA



Model No. MiniGSM

Features

- ◆ Ground plane dependent design
- ◆ Ideal for handheld devices and small terminals

Technical Data

Applicable Bands: 900/1800 MHz
 Radiating Element: Quarter-wave meander line
 VSWR: 2.5 : 1
 Peak Gain: 0 dBi
 Max Input Power: 10 W
 Dimension: 43 x 6 x 0.8 mm
 Cable: RG178
 Connector Type: MMCX or others

Ordering Options

Part Number	Description
FMGB35025-MR-10	Mini-GSM Blade with 100mm RG178 and right-angled MMCX

TRI BAND GSM ANTENNA



Model No. ISIS

Features

- ◆ Ground plane independent design
- ◆ Ideal for handheld devices and access points

Technical Data

Applicable Bands: Tri Band 900/1800/1900 MHz
 Radiating Element: Compacted folded dipole radiating element
 VSWR: 2 : 1
 Peak Gain: 1.0 dBi
 Max Input Power: 10 W
 Dimensions: 60 x 17 x 0.8 mm
 Cable: RG178
 Connector Type: SMA/MCX or others

Ordering Options

Part Number	Description
FISS35063-MR-16	Isis with 160mm RG178 and right-angled MMCX
FISS35063-UF-15	Isis with 150mm RG178 and U.FL
FISS35063-WF-10	Isis with 100mm RG178 and W.FL

TRI BAND GSM ANTENNA

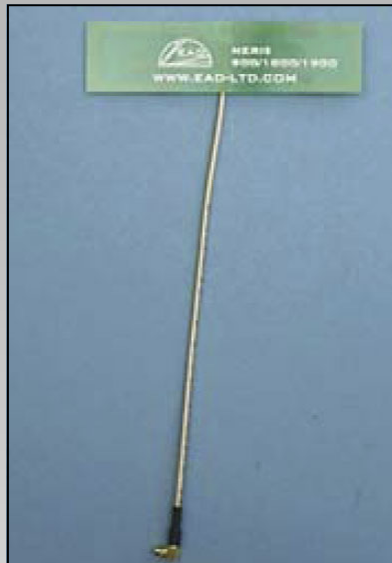

Model No. Neris

Features

- ◆ Ground plane independent design
- ◆ Ideal for cellular terminals

Technical Data

Applicable Bands: Tri Band 900/1800 MHz
 Frequency Range: 880-960/1710-1990,
 Gain: 1.0 dBi
 Max Input Power: 10 W
 Dimension: 81 x 21 x 0.8 mm
 Cable: RG178

Ordering Options

Part Number	Description
FNER35001-MR-10	Neris with 100mm RG178 and right-angle MMCX
FNER35001-MR-16	Neris with 160mm RG178 and right-angle MMCX
FNER35001-SM-10	Neris with 100mm RG178 cable and SMA male
FNER35001-MU-10	Neris with 100mm cable and Murata GSC
FNER35001-UF-10	Neris with 100mm cable and U.FL
FNER35001-MCF-10	Neris with 100mm cable and MCF connector

QUAD BAND GSM ANTENNA

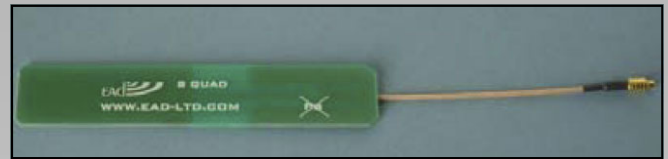

Model No. S-QUAD

Features

- ◆ Ground plane independent design
- ◆ Ideal for cellular terminals

Technical Data

Applicable Bands: Quad Band 850/900/1800/1900 MHz
 Radiating Element: Multi-band monopole with own ground plane
 VSWR: 2 : 1
 Peak Gain: 1.2 dBi
 Max Input Power: 10 W
 Dimensions: 110 x 20 mm
 Cable: RG178

Ordering Options

Part Number	Description
FSQ35058-MR-16	S-Quad with 160mm RG178 cable and right-angled MMCX
FSQ35058-UF-10	S-Quad with 100mm RG178 cable and U.FL

PENTA BAND GSM/3G ANTENNA

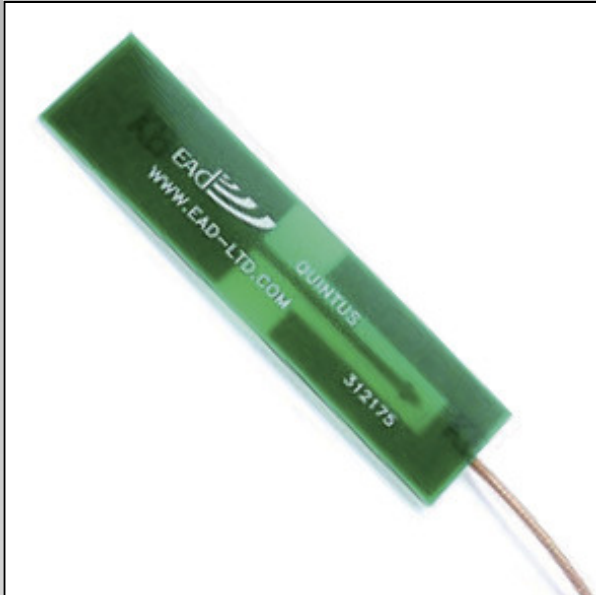

Model No. Quintus

Features

- ◆ Ground plane independent design
- ◆ Covers 850/900/1800/1900/2100 MHz bands
- ◆ Various cable/connector options
- ◆ Ideal for fixed and mobile terminals

Technical Data

Applicable Bands: Penta Band 850/900/1800/1900/2100 MHz

Radiating Element: 1/2 wave element

Gain: 2 dBi

Polarisation: Linear

Return loss: -7.0 dB

Power rating: 10W

Dimensions: 83 x 22mm

Cable / Connector: Various including MMCX, U.FL, SMA

Ordering Options

Part Number	Description
FQTN35144-MR-16	Quintus with 160mm RG-178 and MMCX Connector
FQTN35144-UF-10	Quintus with 100mm RG-178 cable and U.FL Connector

GLYN

High-Tech Distribution

GPS Antennas

GPS ACTIVE ANTENNA

Model No. AGG000D



Technical Data

Dielectric Antenna

Centre Frequency: 1575.42MHz \pm 3MHz
VSWR: 1.5:1
Bandwidth: \pm 5 MHz
Impedance: 50 ohm
Polarization: RHCP

LNA/Filter

LNA Gain (without cable): 28 dB +/-2dB (typical)
Noise Figure: 1.5 dB
DC Voltage: 2.2—5V
DC Current: 5—15mA

Mechanical

Dimension: 43 \times 33 \times 14 mm
Cable: RG174 3m, 5m or others
Connector: MMCX right angle male/MCX straight male or others
Mounting: Magnetic base
Housing: Black

Environmental

Working Temperature: -40°C to +85°C
Humidity: 55% to 75% RH
Waterproof: IP67

GPS ACTIVE ANTENNA

Model No. AGG000H



Technical Data

Dielectric Antenna

Centre Frequency: 1575.42MHz \pm 3MHz
VSWR: 1.5:1
Bandwidth: \pm 5 MHz
Impedance: 50 ohm
Polarization: RHCP

LNA/Filter

LNA Gain (without cable): 28 dB +/-2dB (typical)
Noise Figure: 1.5 dB
DC Voltage: 3—5V
DC Current: 8—15mA

Mechanical

Dimension: 39 \times 33 \times 14 mm
Cable: RG174 3m, 5m or others
Connector: SMA/SMB/MCX/MMCX or others
Mounting: Magnetic base
Housing: Black

Environmental

Working Temperature: -40°C to +85°C
Humidity: 55% to 75% RH
Waterproof: IP67

GPS ACTIVE ANTENNA

Model No. AGG000F



Technical Data

Dielectric Antenna

Centre Frequency: 1575.42MHz \pm 3MHz
VSWR: 1.5:1
Bandwidth: \pm 5 MHz
Impedance: 50 ohm
Polarization: RHCP

LNA/Filter

LNA Gain (without cable): 28 dB +/-2dB (typical)
Noise Figure: 1.5 dB
DC Voltage: 2.2—5V
DC Current: 5—15mA

Mechanical

Dimension: 46 (D) x 15mm
Cable: RG174 3m, 5m or others
Connector: SMA/SMB/MCX/MMCX or others
Mounting: Screw type
Housing: Black

Environmental

Working Temperature: -40°C to +85°C
Humidity: 55% to 75% RH
Waterproof: IP67

GPS PASSIVE ANTENNA

Model No. AGG042



Technical Data

Dielectric Antenna

Centre Frequency: 1575.42MHz \pm 3MHz
VSWR: 1.5:1
Bandwidth: \pm 5 MHz
Impedance: 50 ohm
Polarization: RHCP

Mechanical

Dimension: 40 x 39 x 14mm
Cable: RG174 3m, 5m or others
Connector: SMA/SMB/MCX/MMCX or others
Mounting: Magnetic base
Housing: Black

Environmental

Working Temperature: -40°C to +85°C
Humidity: 55% to 75% RH
Waterproof: IP67

GPS MARINE ACTIVE ANTENNA

Model No. AGG005



Technical Data

Dielectric Antenna

Centre Frequency: 1575.42MHz \pm 3MHz

VSWR: 1.5:1

Bandwidth: \pm 5 MHz

Impedance: 50 ohm

Polarization: RHCP

LNA/Filter

LNA Gain: 28/38/52 dB

Noise Figure: 1.5 dB

DC Voltage: 2.2—5V

Mechanical

Dimension: 94 (D) x 135mm

Cable: RG58 8—30m

GPS ACTIVE ANTENNA

Model No. AGG044

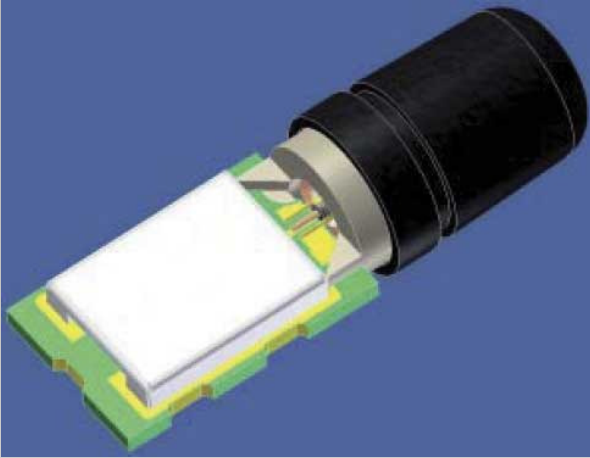

Bandwidth (3dB): 20 MHz
Axial Ratio: <2.0 @Zenith
VSWR: <2.0:1 (typ), 2.3:1 (max)
Impedance: 50
Noise Figure: 1.2 (typ), 1.3 (max) dB
Input 3rd Order Intercept Point: -10 dBm
Operating Temperature: -40 +20 +85 °C
Element Dimensions: 10 (diameter) x 17 (length) mm
Overall Dimensions (w/radome): 13 (dia) x 14.6 (width) x 44 (length) mm
Weight (excl radome or sleeve): 8.4 grams
Mounting: SMT

The AGG044 surface-mount high-gain GPS antenna is the smallest active quadrifilar helix antenna available, providing high performance in difficult GPS applications.

The AGG044 integrates a high-performance, high-gain, low-noise amplifier and is an active antenna ideal in applications where:

- the device is handheld, body-worn, or otherwise surrounded by high-dielectric materials that would de-tune conventional antennas;
- the antenna is tightly integrated with other antennas, e.g., Bluetooth®/GPS receivers or GPS/GSM mobile phones;
- there are tight constraints on the size of the device or the amount of space allocated to ground planes;
- the GPS receiver requires 20dB or more of input pre-amplification;
- the orientation of the device is random; or
- the antenna will be embedded in the device.

The AGG044 antenna is balanced, which isolates it from the device and enables the antenna to reject common mode noise resident on the device ground plane. The construction and materials of the antenna constrain its near-field to a very small volume, therefore materials near the antenna have negligible de-tuning effects and the antenna maintains its pattern and efficiency in the presence of dielectric loading. As a dielectrically-loaded antenna with a high-performance SAW filter, the AGG044 antenna effectively attenuates signals from common GSM and ISM frequencies by as much as 30dB, minimizing the need for additional filtering.

The AGG044 antenna may be deployed in an external, "stub-style" configuration, but it is also a simple antenna to embed due to its isolation properties. The antenna is deployed with either a black radome or an ABS plastic sleeve.

Technical Data

Type: Quadrifilar Helix
Frequency: 1573.42 (min), 1575.42 (typ) 1577.42 (max) MHz
Polarization: Right-hand circular polarized
Voltage: 2.8 (min), 3.3 (typ), 3.6 (max) V
Current: 13 (typ), 15 (max) mA
Gain: +24 (min), +25 (typ) dBic
Beamwidth: 135 Degrees

GPS INTERNAL ACTIVE ANTENNA

Model No. AGG000N



Technical Data

Dielectric Antenna

Centre Frequency: 1575.42MHz \pm 3MHz
VSWR: 1.5:1
Bandwidth: \pm 5 MHz
Impedance: 50 ohm
Polarization: RHCP

LNA/Filter

LNA Gain (without cable): 28 dB (typical)
Noise Figure: 1.5 dB
DC Voltage: 3–5V
DC Current: 5–10mA

Mechanical

Dimension: 27 x 27 x 9mm
Cable: RF174 or others
Connector: MMCX/UFL or others

Environmental

Working Temperature: -40°C to +85°C
Humidity: 55% to 75% RH

GPS INTERNAL ACTIVE ANTENNA

Model No. AGG055

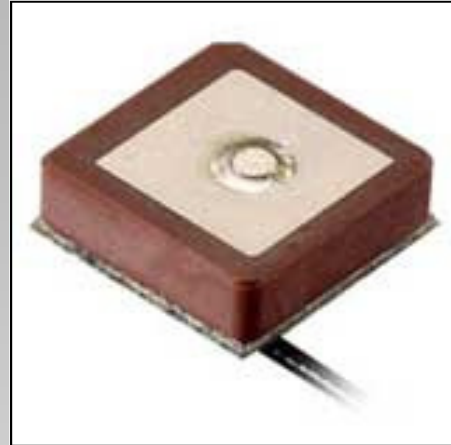

Technical Data

Dielectric Antenna

Centre Frequency: 1575.42MHz \pm 3MHz
VSWR: 1.5:1
Bandwidth: \pm 5 MHz
Impedance: 50 ohm
Polarization: RHCP

LNA/Filter

LNA Gain (without cable): 10–30 dB (typical)
Noise Figure: 1.5 dB
DC Voltage: 2.2–5V
DC Current: 5–15mA

Mechanical

Dimension: 13 x 13 x 6.5mm
Cable: RF1.13 or others
Connector: UFL/MMCX or others

Environmental

Working Temperature: -40°C to +85°C
Humidity: 55% to 75% RH
Waterproof: IP67

GPS INTERNAL PASSIVE ANTENNA

Model No. AGG040

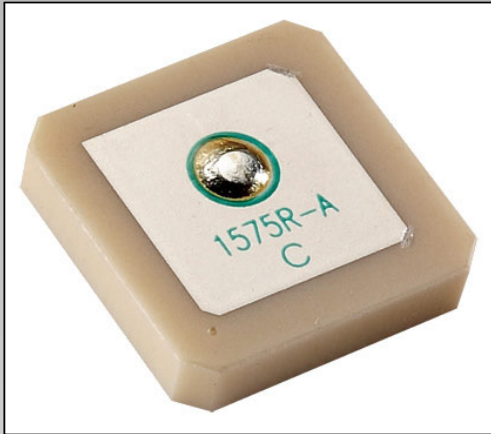

Technical Data

Dielectric Antenna

Centre Frequency: 1575.42MHz \pm 3MHz

VSWR: 1.5:1

Bandwidth: \pm 5 MHz

Impedance: 50 ohm

Polarization: RHCP

Mechanical

Dimension: 20 x 20 x 4mm (other sizes also available)

Cable: RG174 3m, 5m or others

Connector: SMA/SMB/MCX/MMCX or others

Environmental

Working Temperature: -40°C to +85°C

Humidity: 55% to 75% RH

Waterproof: IP67



High-Tech Distribution

GSM + GPS Combo Antennas

COMBO GSM/GPS ANTENNA

Model No. AGC000B

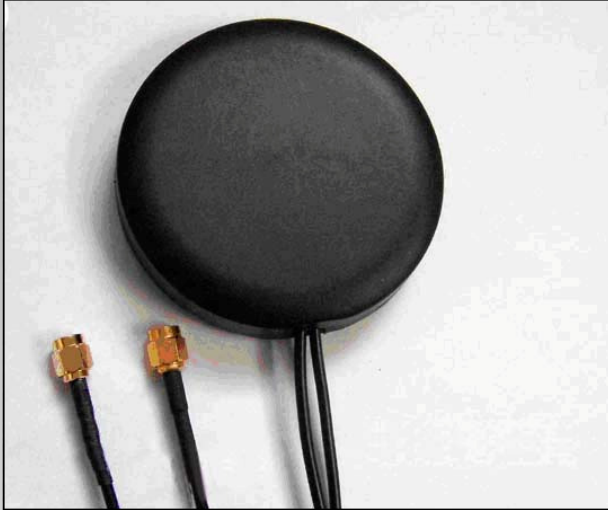

Technical Data

GPS Dielectric Antenna

Centre Frequency: 1575.42 MHz \pm 3 MHz
VSWR: 1.5:1
Bandwidth: \pm 5 MHz
Impedance: 50 ohm
Polarization: RHCP

GSM Antenna

Applicable Bands: Quad Band 850/900/1800/1900MHz
Frequency:
824-894 MHz / 880-960 MHz / 1710-1990 MHz
VSWR: 2.0:1
Impedance: 50 ohm
Typical Gain: 2 dBi

LNA/Filter

LNA Gain (without cable): 30 dB (typical)
Noise Figure: 1.5 dB
DC Voltage: 2.2—5 V
DC Current: 5—15 mA

Mechanical

Size: 80 mm (D) \times 15 mm (H)
Cable: RG174 3m, 5m or others
Connectors: MMCX straight male/SMA/SMB/MCX or others

Environmental

Working Temperature: -40°C to +85°C
Humidity: 55% to 75% RH
Weatherproof: IP67

COMBO GSM/GPS ANTENNA

Model No. AGC000E



Technical Data

GPS Dielectric Antenna

Centre Frequency: 1575.42 MHz \pm 3 MHz
VSWR: 1.5:1
Bandwidth: \pm 5 MHz
Impedance: 50 ohm
Polarization: RHCP

GSM Antenna

Applicable Bands: Quad Band 850/900/1800/1900MHz
Frequency:
824-894 MHz / 880-960 MHz / 1710-1990 MHz
VSWR: 2.0:1
Impedance: 50 ohm
Typical Gain: 2 dBi

LNA/Filter

LNA Gain (without cable): 30 dB (typical)
Noise Figure: 1.5 dB
DC Voltage: 2.2—5 V
DC Current: 5—15 mA

Mechanical

Size: 97 x 36 x 16mm
Cable: RG174 3m, 5m or others
Connectors: SMA/SMB/MCX or others

Environmental

Working Temperature: -40°C to +85°C
Humidity: 55% to 75% RH
Weatherproof: IP67

COMBO GSM/GPS ANTENNA

Model No. AGC057



Technical Data

GPS Dielectric Antenna

Centre Frequency: 1575.42 MHz \pm 3 MHz
VSWR: 1.5:1
Bandwidth: \pm 5 MHz
Impedance: 50 ohm
Polarization: RHCP

GSM Antenna

Applicable Bands: Quad Band 850/900/1800/1900MHz
Frequency:
824-894 MHz / 880-960 MHz / 1710-1990 MHz
VSWR: 2.0:1
Impedance: 50 ohm
Typical Gain: 2 dBi

LNA/Filter

LNA Gain (without cable): 30 dB (typical)
Noise Figure: 1.5 dB
DC Voltage: 2.2–5 V
DC Current: 5–15 mA

Mechanical

Size: 59 x 52 x 15mm
Cable: RG174 2m, 5m or others
Connectors: SMA/SMB/MCX or others

Environmental

Working Temperature: -40°C to +85°C
Humidity: 55% to 75% RH
Weatherproof: IP67

COMBO GSM/3G/GPS ANTENNA

Model No. AGC000K



Technical Data

GPS Dielectric Antenna

Centre Frequency: 1575.42 MHz \pm 3 MHz
VSWR: 1.5:1
Bandwidth: \pm 5 MHz
Impedance: 50 ohm
Polarization: RHCP

GSM Antenna

Applicable Bands: Penta Band 850/900/1800/1900/2100MHz
Frequency Range: 824-894 MHz / 880-960 MHz
1710-1990 MHz / 1920-2170 MHz
VSWR: 2.0:1
Impedance: 50 ohm
Typical Gain: 2 dBi

LNA/Filter

LNA Gain (without cable): 30 dB (typical)
Noise Figure: 1.5 dB
DC Voltage: 2.2–5 V
DC Current: 5–15 mA

Mechanical

Size: 91 x 62 x 62mm
Cable: RG174 3m, 5m or others
Connectors: SMA/SMB/MCX or others

Environmental

Working Temperature: -40°C to +85°C
Humidity: 55% to 75% RH
Weatherproof: IP67

COMBO GSM/GPS ANTENNA

Model No. AGC601

Environmental

Working Temperature: -40°C to +85°C

Humidity: 55% to 75% RH

Weatherproof: IP67



Technical Data

GPS Dielectric Antenna

Centre Frequency: 1575.42 MHz \pm 3 MHz

VSWR: 1.5:1

Bandwidth: \pm 5 MHz

Impedance: 50 ohm

Polarization: RHCP

GSM Antenna

Applicable Bands: Penta Band 850/900/1800/1900/2100 MHz

Frequency:

824-894 MHz / 880-960 MHz

1710-1990 MHz / 1920-2170 MHz

VSWR: 2.0:1

Impedance: 50 ohm

Typical Gain: 2 dBi

LNA/Filter

LNA Gain: 14 dB (typical)

Noise Figure: 1.5 dB

DC Voltage: 2.7—5.5 V

DC Current: 5—15 mA

Mechanical

Size: 68 (D) x 35 mm (H)

Cable: RG174 6m or others

Connectors: SMA/SMB/MCX or others

Dimension (Unit: mm)

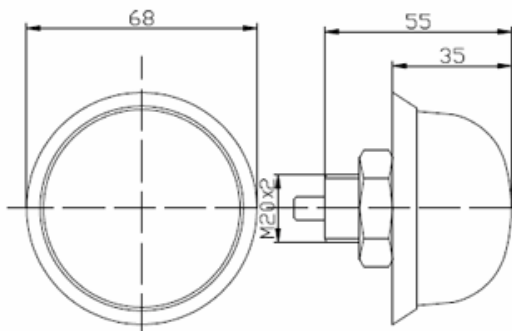



High-Tech Distribution

RF Cables | Pigtails

RF CABLES | PIGTAILS



GLYN can offer any cable length and connector combination. These include SMA, RP-SMA, FME, U.FL, MCX, MMCX, TNC, BNC, Fakra, SMB and almost anything else available!

The options below are common stocked items but with an MOQ of 50pcs we can do any style you want with a typical lead time of 2-3 weeks.

Model No. INTCABLE1

MMCX right angle male/plug + 15cm cable + SMA straight bulkhead female/jack

Model No. INTCABLE2

MMCX straight male/plug + 15cm cable + SMA straight female/jack

Model No. INTCABLE3

MMCX right angle male/plug + 15cm cable + MCX bulkhead female/jack

Model No. INTCABLE4

SMA straight male/plug + 15cm cable + SMA straight bulkhead female/jack

Model No. INTCABLE5

U.FL + 15cm cable + SMA straight bulkhead female/jack (recommended for Bluegiga WT11 and WT41 modules)

Model No. INTCABLE6

MMCX right angle male/plug + 10cm cable + SMB bulkhead female/jack

Model No. INTCABLE7

MMCX right angle male/plug + 7cm cable + MCX bulkhead female/jack

Model No. INTCABLE11

W.FL male + 15cm cable + SMA straight bulkhead female/jack (recommended for Bluegiga WT32-E module)

Model No. INTCABLE16

U.FL + 20cm cable + U.FL

Model No. INTCABLE17

1cm stripped and tinned + 15cm cable + SMA bulkhead female/jack

Model No. INTCABLE28

MMCX right angle male/plug + 15cm cable + MCX bulkhead female/jack

Model No. INTCABLE30

U.FL + 22.5cm cable + SMA bulkhead female/jack

Model No. INTCABLE61

MMCX right angle male/plug + 41cm RG316 cable + RP-SMA bulkhead female/jack

GPS ANTENNA CONFIGURATION

CONFIGURATION:

GSM ANTENNA CONNECTOR TYPE — SMA,SMB,BNC,MCX,MMCX,FME,TNC,SMC or without connector

GPS ANTENNA CONNECTOR TYPE — SMA,SMB,BNC,MCX,MMCX,FME,TNC,SMC

All GPS antennas are shipped with 3.0V - 5.0V supply option unless otherwise specified.

RF CONNECTORS



Recommended Configurations for Telit GSM/GPS Modules

RECOMMENDED CONFIGURATIONS FOR TELIT GSM/GPS MODULES

Telit Modules	Recommended Options	Product Description
GM862-QUAD-PY GM862-QUAD <i>NOTE: Both modules come with a built-in MMCX female connector for the GSM antenna.</i>	Option 1: GSM antenna with built-in cable and MMCX straight male connector	AGM001P (MMCX): GSM antenna + 3 metre cable + MMCX straight male connector
	Option 2: GSM antenna with built-in SMA male connector + SMA female to MMCX male interface cable	AGM000QF (SMA): GSM antenna + SMA right angle male connector, or AGM001P (SMA): GSM antenna + 3 metre cable + SMA straight male connector + INTCABLE1: MMCX right angle male/plug + 15cm cable + SMA straight bulkhead female/jack
GM862-GPS <i>NOTE: GM862-GPS comes with built-in MMCX female connectors for the GSM and GPS antennas.</i>	Option 1: Combo GSM/GPS antenna with built-in cable and MMCX male connectors	AGC000E (MMCX): Combo GSM/GPS antenna + 2 metre cable + MMCX straight male connectors (both GSM and GPS)
	Option 2: Combo GSM/GPS antenna with built-in cable and SMA male connectors + SMA female to MMCX male interface cable	AGC000B (SMA): Combo GSM/GPS antenna + 2 metre cable + SMA straight male connectors, or AGC000E (SMA): Combo GSM/GPS antenna + 2 metre cable + SMA straight male connectors (both GSM and GPS) + INTCABLE1: MMCX right angle male/plug + 15cm cable + SMA straight bulkhead female/jack



GM862-QUAD-PY
GM862-QUAD

RECOMMENDED CONFIGURATIONS FOR TELIT GSM/GPS MODULES

Telit Modules	Recommended Options	Product Description
<p>GM862-GPS</p> <p><i>NOTE: GM862-GPS comes with built-in MMCX female connectors for the GSM and GPS antennas.</i></p>	<p>Option 3: Separate GSM and GPS antennas. Either direct MMCX connection or SMA with interface cable option can be selected.</p>	<p>GSM PART:</p> <p><u>MMCX Option:</u> AGM001P (MMCX): GSM antenna (900/1800 MHz) + 3 metre cable + MMCX straight male connector</p> <p><u>SMA Option:</u> AGM000Q (SMA): GSM antenna (900/1800 MHz) + SMA right angle male connector, <i>or</i></p> <p>AGM001P (SMA): GSM antenna (900/1800 MHz) + 3 metre cable + SMA straight male connector</p> <p style="text-align: center;">+</p> <p>INTCABLE1: MMCX right angle male/plug + 15cm cable + SMA straight bulkhead female/jack</p> <p>GPS PART:</p> <p><u>MMCX Option:</u> AGC000D (MMCX): GPS active antenna + 2 metre cable + MMCX straight male connector</p> <p><u>SMA Option:</u> AGC000D (SMA): GPS active antenna + 2 metre cable + SMA straight male connector</p> <p style="text-align: center;">+</p> <p>INTCABLE1: MMCX right angle male/plug + 15cm cable + SMA straight bulkhead female/jack</p>

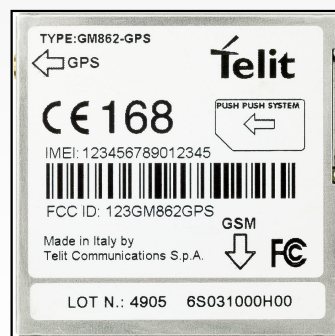
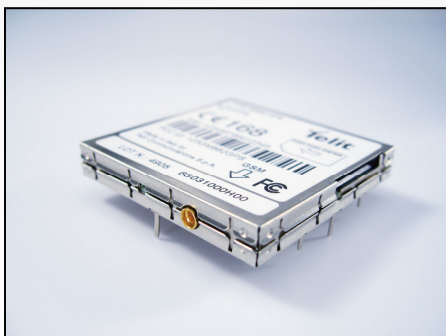

GM862-GPS

Sample GM862-QUAD/QUAD-PY Configuration with Direct MMCX Connection

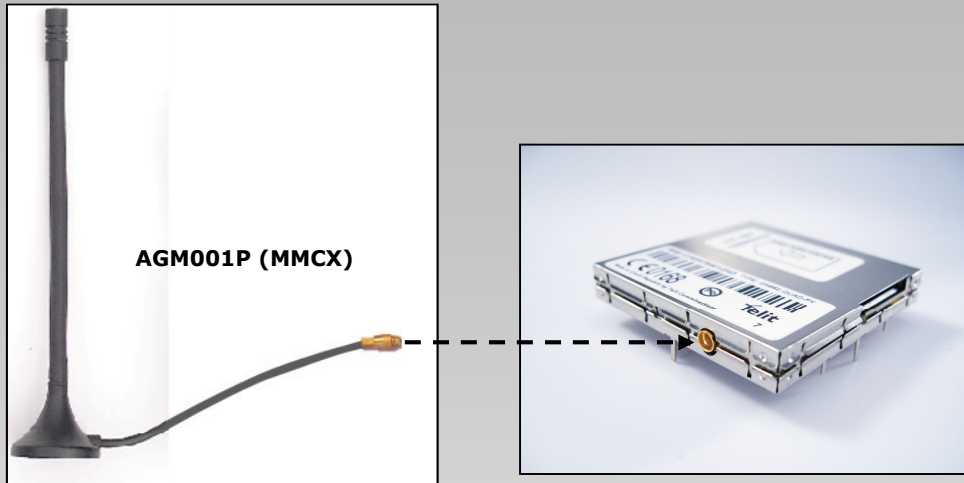

Sample GM862-QUAD/QUAD-PY Configuration using SMA to MMCX Interface Cable

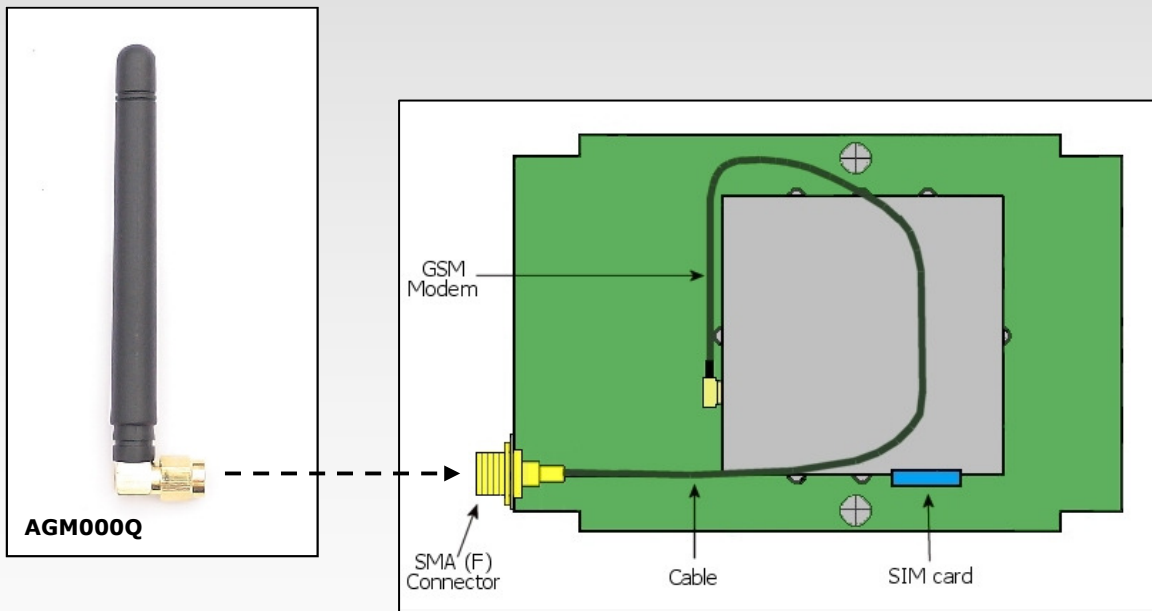

Sample GM862-GPS Configuration with Combo GSM/GPS Antenna with Direct MMCX Connections

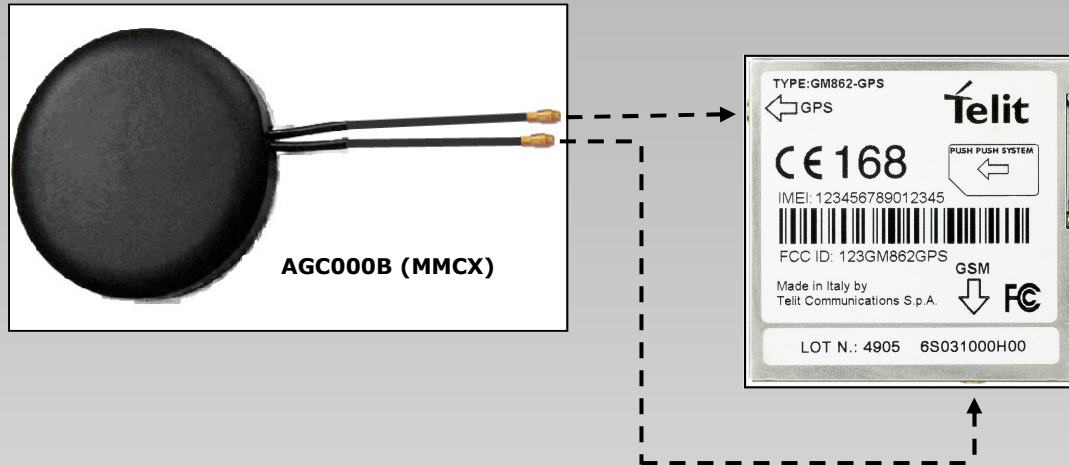

Sample GM862-GPS Configuration with Separate GSM and GPS Antennas with Direct MMCX Connections

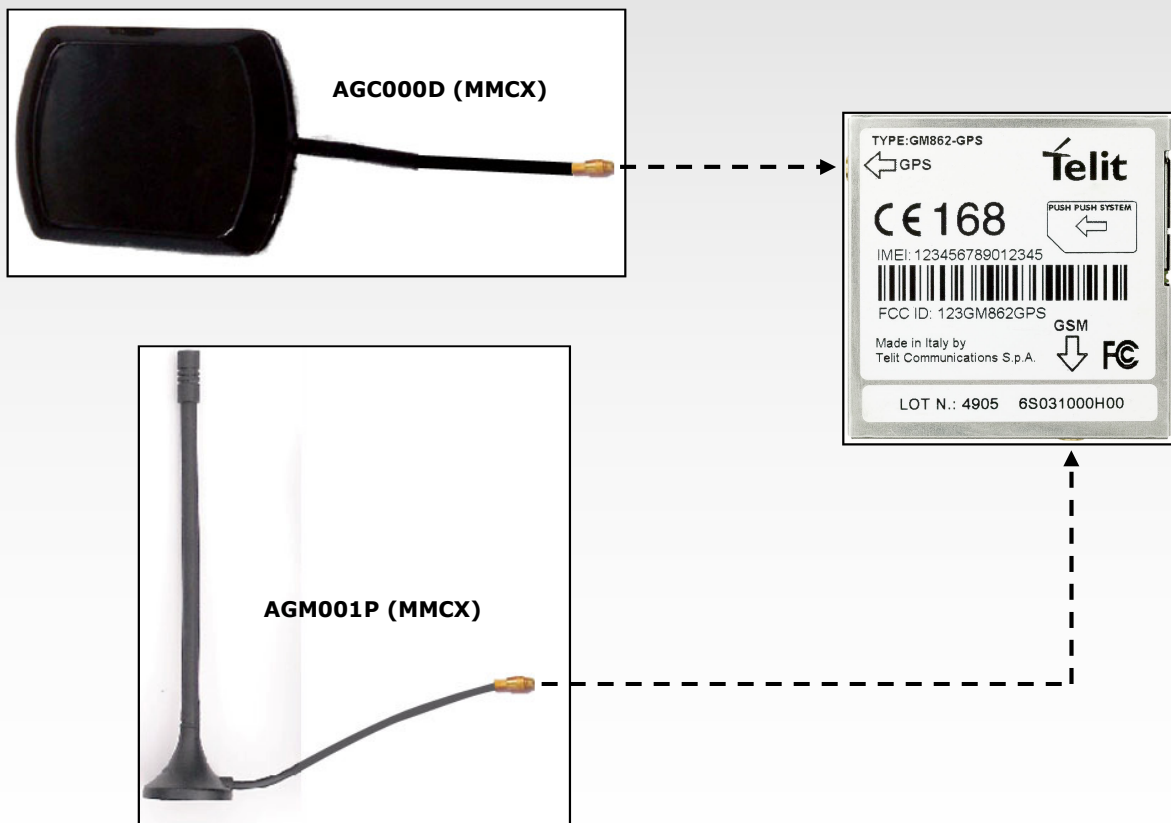



High-Tech Distribution

GLYN Standard Parts (Stocked Items)

GLYN STANDARD PARTS (STOCKED ITEMS)

Part Number	Description
AGM000Q	Flexible GSM antenna, Quad Band 850/900/1800/1900 MHz , SMA right angle connector
AGM000QF	Flexible GSM antenna, Quad Band 850/900/1800/1900 MHz , SMA adjustable-angle connector
AGM001P (SMA Straight)	GSM/3G antenna, Penta Band 850/900/1800/1900/2100 MHz , 3 metre cable, SMA straight male connector, magnetic mounting
AGM001P (MMCX)	GSM antenna, Penta Band 850/900/1800/1900/2100 MHz , 3 metre cable, MMCX straight male connector, magnetic mounting
AGM002P (SMA)	GSM antenna, Penta Band 850/900/1800/1900/2100MHz , 3 metre cable, SMA straight male connector, adhesive mounting
AGM024P (SMA)	GSM/3G antenna, Penta Band 850/900/1800/1900/2100MHz , 2 and 5 metre cable, SMA straight male connector
Isis (RA MMCX)	GSM internal antenna, Tri Band 900/1800/1900 MHz, 10cm cable MMCX right-angled connector
Isis (U.FL)	GSM internal antenna, Tri Band 900/1800/1900 MHz, 10cm cable U.FL connector
Quintus (MMCX)	GSM/UMTS internal antenna, Penta Band 850/900/1800/1900/2100 MHz, 160mm RG-178 and MMCX Connector
Quintus (U.FL)	GSM/UMTS internal antenna, Penta Band 850/900/1800/1900/2100 MHz, 100mm cable and U.FL Connector
AGG000D (SMA)	GSM antenna, magnetic mounting, 3 metre cable, SMA straight male connectors
AGG000D (MMCX)	GSM antenna, magnetic mounting, 3 metre cable, MMCX straight male connectors
AGG000D (MCX)	GSM antenna, magnetic mounting, 3 metre cable, MCX straight male connectors
AGG000H (SMA)	GSM antenna, magnetic mounting, 3 metre cable, SMA straight male connectors
AGC000B (SMA)	Combo GSM/GPS antenna, magnetic mounting, 2 metre cable, SMA straight male connectors
AGC000B (MMCX)	Combo GSM/GPS antenna, magnetic mounting, 2 metre cable, MMCX straight male connectors
AGC000E (SMA)	Combo GSM/GPS antenna, magnetic mounting, 2 metre cable, SMA straight male connectors
INTCABLE1	MMCX right angle male/plug + 15cm cable + SMA straight bulkhead female/jack
INTCABLE4	MMCX straight male/plug + 15cm cable + SMA straight female/jack
INTCABLE5	U.FL + 15cm cable + SMA straight bulkhead female/jack (recommended for WT11 and WT41 modules)

NOTE: Non-stocked options (e.g. different connector or cable length) has MOQ of 50pcs.